



## 1 Smithfield View Close, Belper, DE56 1QF

£595 Per Calendar Month

- Detached Bungalow
- Shower Room
- Electric Heating
- Available Immediately
- One Bedroom
- New Carpet Being Fitted In The Lounge Area
- Awaiting EPC
- Open Plan Living Kitchen
- Water Bills Included In The Rent
- Unfurnished

## Ground Floor

Approx. 33.4 sq. metres (359.6 sq. feet)

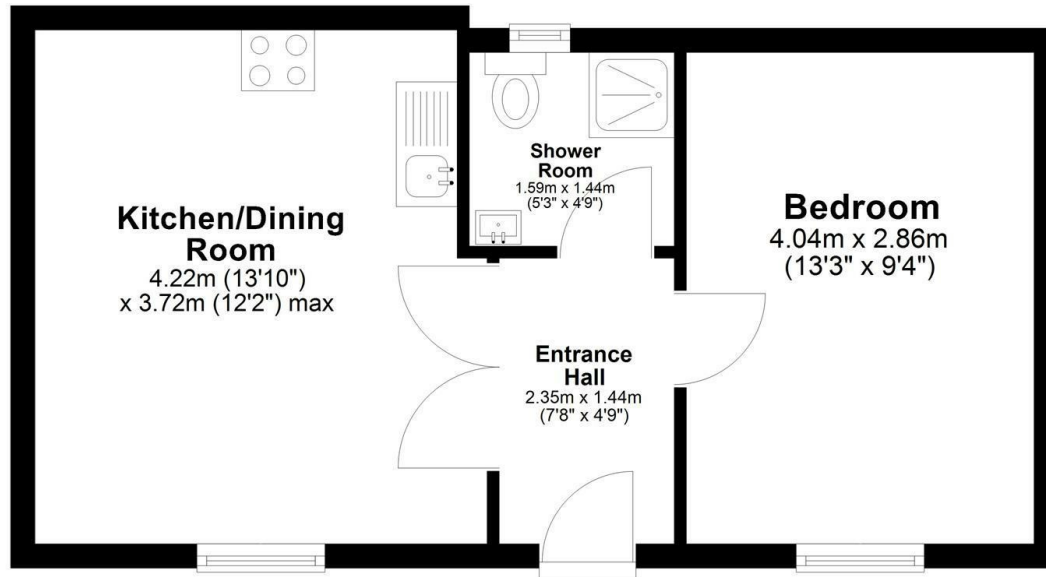

Total area: approx. 33.4 sq. metres (359.6 sq. feet)

## Directions

## Viewings

Viewings by arrangement only. Call 01332 910111 to make an appointment.

## Council Tax Band

A

## EPC Rating:

D

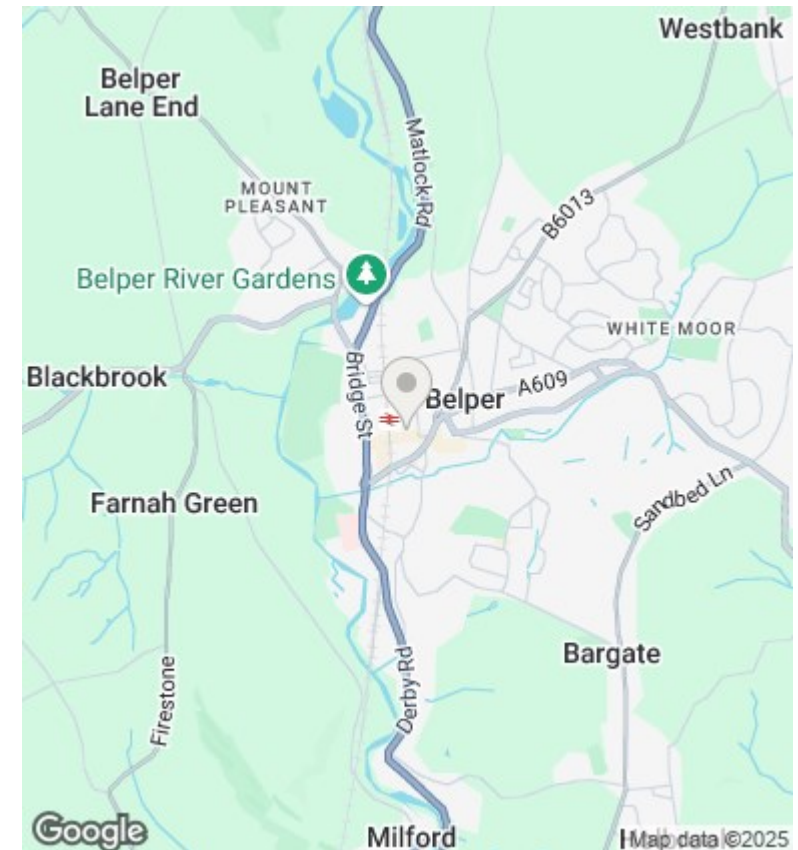

Energy Efficiency Rating		
	Current	Potential
Very energy efficient - lower running costs		
(92 plus) <b>A</b>		<b>97</b>
(81-91) <b>B</b>		
(69-80) <b>C</b>		
(55-68) <b>D</b>	<b>65</b>	
(39-54) <b>E</b>		
(21-38) <b>F</b>		
(1-20) <b>G</b>		
Not energy efficient - higher running costs		
England & Wales		EU Directive 2002/91/EC